



Rivenhall Way, Rochester, ME3 9GF  
Asking price £400,000

 4  2  2  C

**THE PERFECT FAMILY HOME** - This very well presented four double bedroom link semi-detached house offers spacious and versatile accommodation throughout. On the ground floor is the 24' kitchen/diner benefitting from views of the countryside plus a recently upgraded kitchen with integrated appliances and range cooker and cloakroom. On the first floor is the living room, study/5th bedroom and the large master bedroom suite with fitted wardrobes and en-suite shower room. The top floor is home to three further double bedrooms and the family bathroom. Externally the home benefits from a larger garden, covered parking for two cars and a garage which is currently being used as a gym & fitness facility. The home is located within a well maintained modern development with children's play areas. Primary and Academy education facilities, shops and leisure facilities are within a few minutes drive.

**Entrance Hall**

**Kitchen/Diner**  
24'1" x 10'8" (7.34m x 3.25m)

**Lobby**

**Ground Floor Cloakroom**

**First Floor Landing**

**Living Room**  
15'2" x 13'5" at maximum point (4.62m x 4.09m at maximum point)

**Study/Bedroom Five**  
8'7" x 6'9" (2.62m x 2.06m )

**Master Bedroom**  
16'11" x 9'2" (5.16m x 2.79m)

**En-Suite**

**Top Floor Landing**

**Bedroom Two**  
13'11" x 10'2" (4.24m x 3.10m)

**Bedroom Three**  
12'2" x 11'10" (3.71m x 3.61m)

**Bedroom Four**  
12'3" x 9'5" (3.73m x 2.87m )

**Family Bathroom**

**Garden**

**Garage - currently used as a gym**

**Covered Parking**  
24'1" x 9'2" (7.34m x 2.79m )





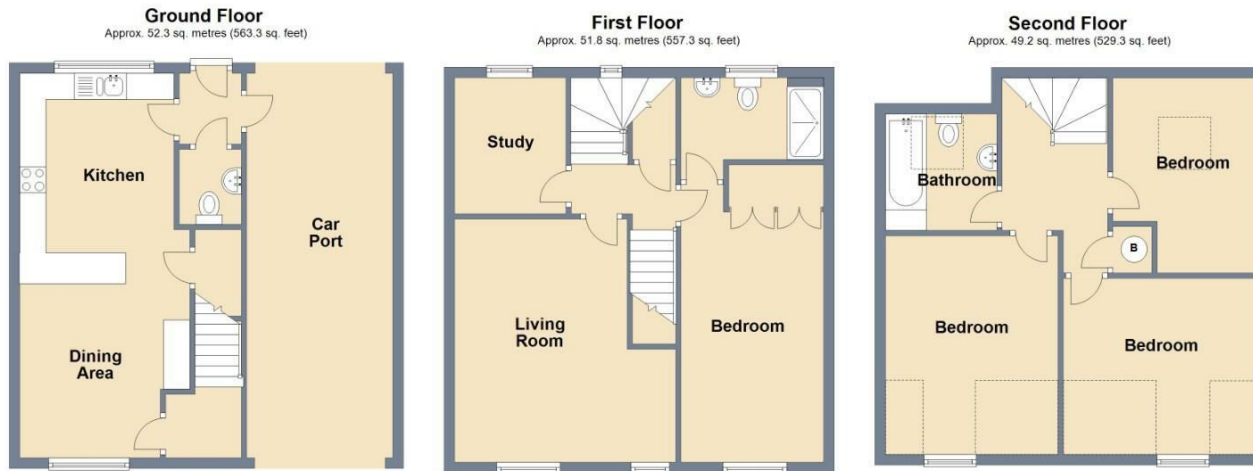

Total area: approx. 153.3 sq. metres (1649.9 sq. feet)

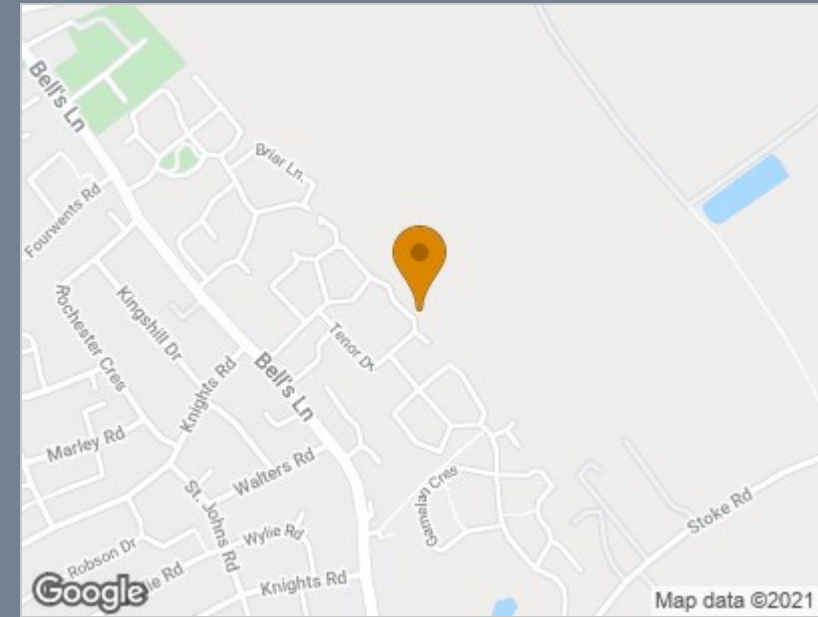

Energy Efficiency Rating		Current	Potential
Very energy efficient - lower running costs			
(92 plus) <b>A</b>			
(81-91) <b>B</b>		80	87
(69-80) <b>C</b>			
(55-68) <b>D</b>			
(39-54) <b>E</b>			
(21-38) <b>F</b>			
(1-20) <b>G</b>			
Not energy efficient - higher running costs			
<b>England &amp; Wales</b>	EU Directive 2002/91/EC		

## Viewing

Please contact our The Homes Group Office on 01322 532 889 if you wish to arrange a viewing appointment for this property or require further information.

These particulars, whilst believed to be accurate are set out as a general outline only for guidance and do not constitute any part of an offer or contract. Intending purchasers should not rely on them as statements of representation of fact, but must satisfy themselves by inspection or otherwise as to their accuracy. No person in this firm's employment has the authority to make or give any representation or warranty in respect of the property.